

Hangzhou Xixi National Wetland

By Sunlay + RHINESCHEME GmbH

Location: Hangzhou, Zhejiang, China

Surface: 4722.0 sqm

Year of Completion:
2012

Green Solutions Used:

- Ground source heat pump
- Thermal and photovoltaic use of solar energy,
- Light pipe,
- Green roof,

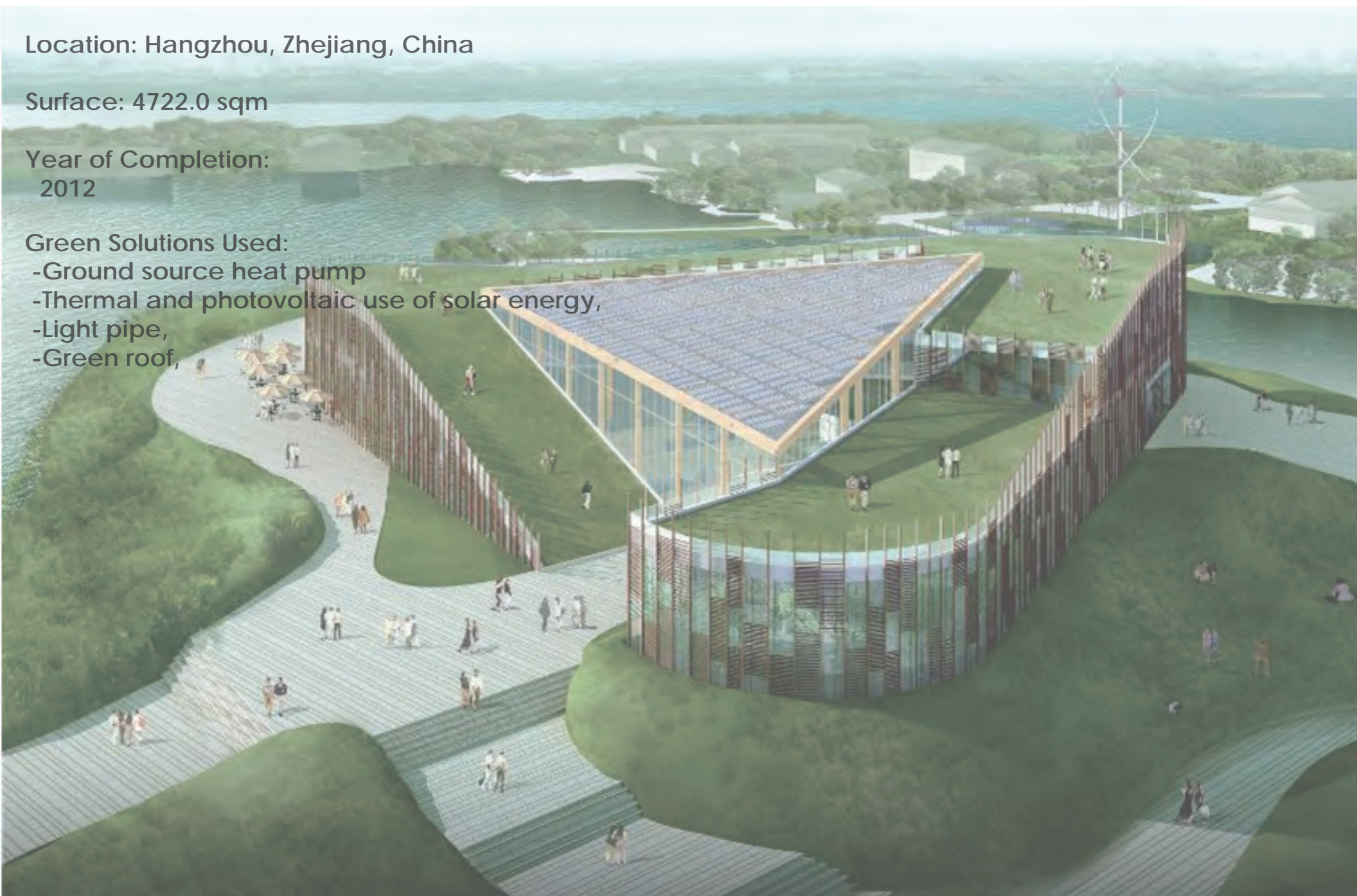

Located at Long Shezui Area of Hangzhou Xixi National Wetland Park, the third phase of the project is designed as 'green buildings' and provides different functional areas including visitor center, ecological exhibition, ecological education, office, meeting and dining. The overall approach features 'Xixi', wetland, ecology and bionic environment. The ecological exhibition area consists of one upper and lower floor that provides plants growing and exhibition. The ecological education area cooperates with the ecological environment research center of Zhejiang University, providing students an education site that is a ideal location for outdoors studies.



GREEN SOLUTION

The green energy-saving building shows passive design methods in its use of **natural lighting**, **natural ventilation**, **external cladding structure** and **sunshade system**. It uses integrated design method that efficiently adopt a **ground source heat pump**, **thermal and photovoltaic use of solar energy**, **light pipe**, **green roof**, **integrated treatment and utilization of water**, and **building energy intelligent management system**. Interior design makes full use of environmental protection material, local fast-growing material and recyclable material, embodying the concept of a green building.



Considering the green building integrated intelligent control and simulation analysis, architects attempt to save energy consumption to the fullest, in the context of satisfying the user needs. Energy usage can be reduced 80%, achieving

LEED Platinum Certification
and
A THREE-STAR RATING



Architects: Sunlay, RHINESCHEME GmbH

Location: Hangzhou, Zhejiang, China

Design Team: Zhang Hua, Fan Li, Li Jianguan, wolf loebel, Li Ran, Lukasz Piasta, Zhang Xin

Area: 4722.0 sqm

Year: 2012

Photographs: Shu He Photography

MAKE YOUR BUILDING GREENER, CONTACT *Seeder* TODAY!

info@seeder.cc

